

No.	Name	Material
1	Plug	Polyamide
2	Nail	Polyamide

Building materials

Qualities



Characteristics

- With glass-Fiber reinforced polyamide pin.
- Resistant in meteorological conditions
- Temperature range from -40°C up to +70°C.
- Resistant to cold and heat.

Applications

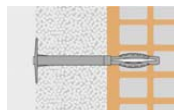

- For general purpose use in hard and soft insulation pads.
- Application on most building materials.
- Anchor of insulation thickness up to 180 mm.

Installation

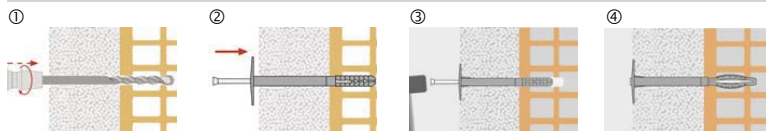

- ① Take drill hole-Ø and drill hole depth from the table.
- ② Set until head lies flush on insulation surface.
- ③ Drive-in the nail with a hammer.
- ④ Nail has to be hammered precisely into the head.

All information detailed in our data sheets is based on technical approvals, formulas and site and laboratory testing under optimum conditions and include a stated safety factor. As we have no direct or indirect control over where or how our products are applied or installed, we do not accept any liability either directly or indirectly arising from the use of our products, whether or not in accordance with any advice, specification or recommendation given by us and we recommend site testing of all products for suitability.

Plug size		10						
Recommended tension loads ¹⁾ :								
N _{Emp}	- Concrete C20/25 - C50/60	0.25						
	- Aerated concrete	0.15						
	- Perforated brick	0.2						
h _{ef}	Effective anchorage depth	Concrete	30					
		Aerated concrete	40					
		Perforated brick	40					
h ₁	Drilling depth	Concrete	40					
		Aerated concrete	50					
		Perforated brick	50					
d ₀	Drill hole-Ø in the building material	10						
d _k	Plug plate-Ø	50						
l	Plug length	70	90	110	130	150	180	210
d _{nom}	Plug-Ø	10						
t _{fix}	Assembling length usable concrete	40	60	80	100	120	150	180
	Assembling length usable Aerated concrete	40	60	80	100	120	150	180
	Assembling length usable perforated brick	30	50	70	90	110	140	170



Insulation Fixing

1) Safety factor 3

Disc Ø 90 mm

