

No.	Name	Material
1	Metal Frame Anchor	Zinc plated steel

Building materials



Inspection report



Qualities



Characteristics



- ① End Caps
- Suitable for hollow masonry.
- Stress-free distance fixing.
- Zinc coated for optimum corrosion prevention.
- Fire proof up to F 120.

- Expansion cone is incaptavated in sleeve.
- Recessed-screw for Pozidrive and Phillips-screwdriver.
- Ideal for high tension and shear loads.
- Easy adjustment.

Applications

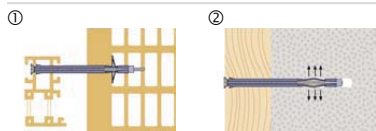

- ① Fixing in perforated brick.
- ② Fixing in solid building materials.
- Fixing in various base materials, after the expansion of the legs. It guarantees a positive-fit connection.

- Fast through fixing and distance assembling.
- Form fit – Shoulder on the plug neck locks behind the hollow section and holds it in place, see ①

Installation

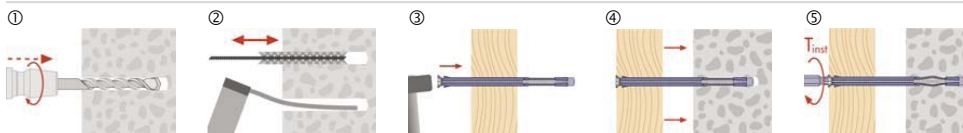

- ① Take drill hole-Ø and drill hole depth from the table.
- ② Clean the drill hole with a brush, then blow it out with a purging pump (not necessary with perforated brick).
- ③ Drive the Metal Frame Anchor into the Building materials.
- ④ Position the Building materials with the Metal Frame Anchor in the drill hole and align it.
- ⑤ Tighten the screw with the predetermined T_{inst} .

All information detailed in our data sheets is based on technical approvals, formulas and site and laboratory testing under optimum conditions and include a stated safety factor. As we have no direct or indirect control over where or how our products are applied or installed, we do not accept any liability either directly or indirectly arising from the use of our products, whether or not in accordance with any advice, specification or recommendation given by us and we recommend site testing of all products for suitability.

Recommended loads: ¹⁾							
N _{Emp}	- Concrete C25 - C55	kN	0.5				
	- Brick		0.4				
	- Perforated brick		0.3				
	- Aerated concrete		0.2				
Shear load			0.5				
M _{Emp}	Bending moment	Nm	2.6				
c	Min. distance to the edge	mm	100				
s	Min. distance betw. anchors	mm	200				
h _{min}	Min. thickness of foundation	mm	100				
h _{ef}	Effective anchorage depth	mm	65				
d _s	Screw-Ø	M	6				
T _{inst}	Torque at anchoring	Nm	8				
h ₁	Min. drill hole depth	mm	80				
d ₀	Drill hole -Ø in the building material	mm	10				
d _{cut}	Drill-Ø max	mm	10.45				
d _f	Hole-Ø in the attached part	mm	10.5				
d _k	Ø head	mm	13				
l	Sleeve length	mm	110	130	150	180	200
d _{nom}	Outside-Ø plug	mm	10				
t _{fix}	Assembling length usable	mm	45	65	85	115	135



Metal Frame Anchor

1) Without influence of anchor and edge distance / Safety factor 5