

No.	Name	Material
1	Metal Frame Anchor	Zinc plated steel

Building materials



Characteristics

Approvals



Qualities



- Tension load for light ceiling fixings according to DIN 18168.
- Stress-free distance fixing of window and door frames.
- Zinc coated for optimum corrosion prevention.
- Fire proof up to F 120

- Expansion cone is incaptavated in sleeve.
- Recessed-screw for Pozidrive and Philips-screwdriver.
- Ideal for high tension and shear forces.
- Easy adjustment.

Applications

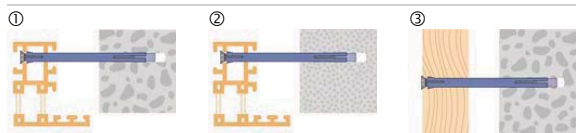

- ① Stress-free distance fixing of profiles in solid building materials.
- ② Stress-free distance fixing of profiles in soft building materials.
- ③ Distance fixing of battens.

- Fast through fixing and distance assembling.
- Form fit – shoulder on the plug neck locks behind the hollow section and holds in place, see ① and ②

Installation

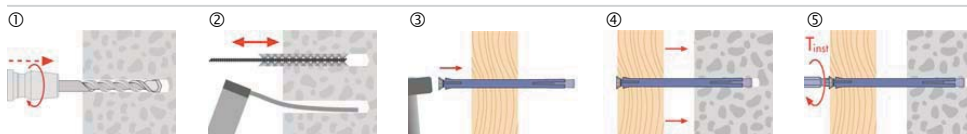

- ① Take drill hole-Ø and drill hole depth from the table.
- ② Clean the drill hole with a brush, then blow it out with a purging pump.
- ③ Drive the Metal Frame Anchor into the Building materials.

- ④ Position the Building materials with the Metal Frame Anchor in the drill hole and align it.
- ⑤ Tighten the screw with predetermined T_{inst} .

All information detailed in our data sheets is based on technical approvals, formulas and site and laboratory testing under optimum conditions and include a stated safety factor. As we have no direct or indirect control over where or how our products are applied or installed, we do not accept any liability either directly or indirectly arising from the use of our products, whether or not in accordance with any advice, specification or recommendation given by us and we recommend site testing of all products for suitability.

Anchor size		8mm				10mm						
		Mushroom head PZ2				Countersunk PZ3						
N _{Zul}	Approved tension load Concrete C25 - C55 ¹⁾	kN				0.5						
V _{Zul}	- Approved shear load	kN				0.5						
M _{Zul}	- Approved bending moment	Nm				2.6						
c	Min. distance to the edge	mm				45						
s	Min. distance betw. anchors	mm				90						
h _{min}	Min. thickness of foundation	mm				60						
h _{ef}	Effective anchorage depth	mm				30						
d _s	Screw-Ø	M				5						
T _{inst}	Torque at anchoring	Nm				5						
h ₁	Min. drill hole depth	mm				45						
d ₀	Drill hole-Ø in the building material	mm				8						
d _{cut}	Drill-Ø max	mm				8.45						
d _i	Hole-Ø in the attached part	mm				8.5						
d _k	Ø head	mm				9						
l	Sleeve length	70	90	110	130	70	90	110	130	150	180	200
d _{nom}	Outside-Ø plug	mm				8						
t _{fix}	Assembling length usable	40	60	80	100	30	50	70	90	110	140	160



Metal Frame Anchor

Recommended loads

Anchor size		8mm				10mm			
		Mushroom head PZ2				Countersunk PZ3			
Recommended loads: ²⁾									
N _{Emp}	- Concrete C25 - C55	kN				0.75			
	- Brick	kN				0.5			
	- Aerated concrete	kN				-			
V _{Emp}	Shear load	kN				0.3			
M _{Emp}	Bending moment	Nm				1.8			

1) For fixing of light weight suspended ceilings according to DIN 18168

2) Without influence of anchor and edge distance / Safety factor 5