

No.	Name	Material
1	Anchor	Zinc plated steel

Building materials

Qualities



Characteristics

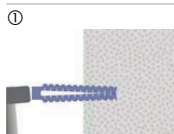

- Hammer-in directly into thermalite block without pre-drilling
- For use with wood-, self-tapping and hexagon screws
- Fire resistant

Applications

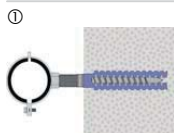

- ① Fixings of pipe clips.
- Fixings in the sanitary industry, hand rails etc.

Installation

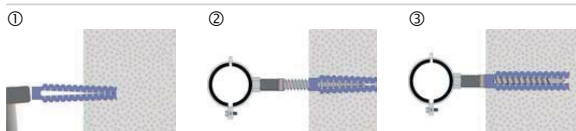

- ① Hammer-in directly into the thermalite block without pre-drilling.
- ⚠ All other buildings materials pre-drill. (Separate drill Ø needed to overcome the resistance in the various building materials).
- ② Screw in the element to be fitted.

All information detailed in our data sheets is based on technical approvals, formulas and site and laboratory testing under optimum conditions and include a stated safety factor. As we have no direct or indirect control over where or how our products are applied or installed, we do not accept any liability either directly or indirectly arising from the use of our products, whether or not in accordance with any advice, specification or recommendation given by us and we recommend site testing of all products for suitability.

Anchor size		6 / 32	8 / 38	8 / 60	10 / 60
Recommended tension loads ¹⁾ :					
N _{Emp}	- Thermalite block	0.22	0.40	0.47	0.52
	- Concrete C25 - C55	0.42	0.72	0.97	1.20
	- Perforated brick	0.37	0.52	0.55	0.62
d _s	For screw-Ø	5-6	6-8		8-10
d ₀	Drill hole-Ø in the building material	7-9	10-12		12-14
l	Anchor length	32	38	60	60
d _{nom}	Outside-Ø anchor	6	8		10



1) Separate drill Ø needed to overcome the resistance in the various building materials. The harder the material, the larger the drill Ø. / Safety factor 3