

No.	Name	Material	No.	Name	Material
1	Hexagon screw	Zinc plated steel yellow chrom.	3	Expansion sleeve	Zinc plated steel yellow chrom.
2	Washer	Zinc plated steel yellow chrom.	4	Expansion cone	Zinc plated steel yellow chrom.

Building materials

Qualities



Characteristics

- Sleeve Anchor with pre-assembled hexagon screw.
- Small anchor and edge distances.
- Controlled expansion.
- Reliable distribution of force in the drilled hole.
- User-friendly assembling.

Applications

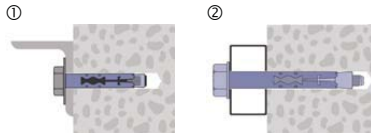

- ① Assembling of connecting constructions.
- ② Assembling of metal profiles.
- Economical and controlled fastening for low and middle heavy duty sector.

Installation

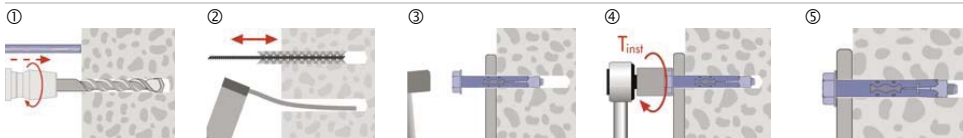

- ① Drilling with depth gauge rod. Take drill hole-Ø and drill hole depth from the table.
- ② Clean the drill hole with a brush, then blow it out with a purging pump.
- ③ Position pre-drilled Building materials, drive in the Sleeve Anchor.
- ④ Tighten the screw with a torque spanner to the predetermined value T_{inst} .
- ⑤

All information detailed in our data sheets is based on technical approvals, formulas and site and laboratory testing under optimum conditions and include a stated safety factor. As we have no direct or indirect control over where or how our products are applied or installed, we do not accept any liability either directly or indirectly arising from the use of our products, whether or not in accordance with any advice, specification or recommendation given by us and we recommend site testing of all products for suitability.

Anchor size		M6	M 8	M 10				
Recommended tension loads concrete ¹⁾ :								
N _{Emp}	- Concrete C20/25 - C50/60	2	3	5				
	- Brick	1.5	1.8	3.2				
	- Sandstone	1.4	2	3.4				
Recommended shear loads ¹⁾ :								
V _{Emp}	- Concrete C20/25 - C50/60	3.2	3.5	6				
	- Brick	1.9	2.8	3.8				
	- Sandstone							
c	Min. distance to the edge	mm	55	60	75			
s	Min. distance betw. anchors	mm	105	120	150			
h _{min}	Min. thickness of foundation	mm	70	80	100			
M _{Emp}	Recommended bending moment steel 4.6	Nm	4.2	5.3	12.8			
h _{ef}	Effective anchorage depth	mm	35	40	50			
SW	Spanner size	mm	10	13	17			
T _{inst}	Torque at anchoring	Nm	8	25	40			
h ₁	Drill hole depth	mm	55	60	70			
d ₀	Drill hole-Ø in the Building materials	mm	8	10	12			
d _f	Hole-Ø in the attached part	mm	9	11	14			
l	Anchor length	mm	45	60	60	80	70	100
d _{nom}	Outside-Ø of the anchor	mm	8	10	12			
t _{fix}	Assembling length usable	mm	5	15	15	25	15	35



Sleeve Anchor

1) Without influence of anchor and edge distance / Safety factor 3

Data also applies to countersunk and roundhead versions