

No.	Name	Material	No.	Name	Material
1	Hexagon Nut	Zinc plated steel yellow chromized	3	Cone throughbolt	Zinc plated steel yellow chromized
2	Expansion sleeve	Zinc plated steel yellow chromized			

Building materials



C20/25
C50/60

Characteristics

Qualities



- Sleeve Anchor with pre-assembled cone throughbolt.
- Small anchor and edge distances.
- Controlled expansion.
- Reliable distribution of force in the drilled hole.
- User-friendly assembling.

Applications

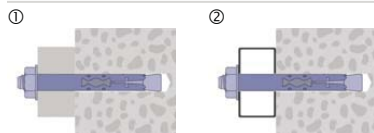

- ① Assembling of connecting constructions.
- ② Assembling of metal profiles.
- Economical and controlled fastening for low and middle duty sector.

Installation

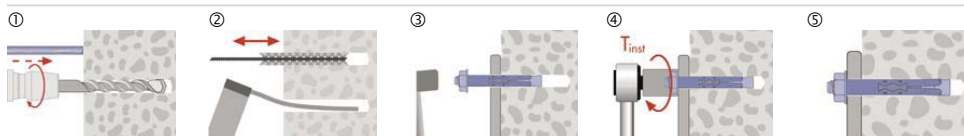

- ① Drilling with depth gauge rod. Take drill hole- \varnothing and drill hole depth from the table.
- ② Clean the drill hole with a brush, then blow it out with a purging pump.
- ③ Position pre-drilled Building materials, drive in the Sleeve Anchor.
- ④ Tighten the nut with a torque spanner to the predetermined value T_{inst} .

All information detailed in our data sheets is based on technical approvals, formulas and site and laboratory testing under optimum conditions and include a stated safety factor. As we have no direct or indirect control over where or how our products are applied or installed, we do not accept any liability either directly or indirectly arising from the use of our products, whether or not in accordance with any advice, specification or recommendation given by us and we recommend site testing of all products for suitability.

Anchor size		M6	M 8	M 10	M 12								
Recommended tension loads ¹⁾ :													
N _{Emp}	- Concrete C20/25 - C50/60	2	3	5	7.5								
	- Brick	1.5	1.8	3.2	4								
	- Sandstone	1.4	2	3.4	4.5								
Recommended shear loads ¹⁾ :													
V _{Emp}	- Concrete C20/25 - C50/60	3.2	3.5	6	8.5								
	- Brick	1.9	2.8	3.8	5.5								
	- Sandstone												
c	Min. distance to the edge	mm	55	60	75	115							
s	Min. distance betw. anchors	mm	105	120	150	225							
h _{min}	Min. thickness of foundation	mm	70	80	100	150							
M _{Emp}	Recommended bending moment steel 4.6	Nm	4.2	5.3	12.8	25							
h _{ef}	Effective anchorage depth	mm	35	40	50	75							
SW	Spanner size	mm	10	13	15	19							
T _{inst}	Torque at anchoring	Nm	8	25	40	50							
h ₁	Drill hole depth	mm	55	60	70	95							
d ₀	Drill hole-Ø in the building material	mm	8	10	12	16							
d _f	Hole-Ø in the attached part	mm	9	12	14	18							
l	Anchor length	mm	40	65	50	75	95	75	100	130	65	110	145
d _{nom}	Outside-Ø of the anchor	mm	8			10			12				16
t _{fix}	Assembling length usable	mm	5	25	5	30	50	15	40	70	5	25	60



Sleeve Anchor

1) Without anchor and edge distance / Safety factor 3

Data also applies to stainless steel version