

No.	Name	Material	No.	Name	Material
1	Cavity Toggle MF-M	Zinc plated steel	4	Wings	Zinc plated steel
2	Cavity Toggle MF-H	Zinc plated steel	5	Nut with washer	Zinc plated steel
3	Cavity Toggle MF-MM	Zinc plated steel	6	Slotted sleeve washer	Brass

Building material

Qualities



Characteristics

- The Cavity Toggle is a special cavity wall anchor made of steel.
- The wings open independently by a spring action.
- For small cavity depth.
- With hook = MF-H / with threaded rod = MF-M
- Fire resistant
- Easily assembled.

Applications

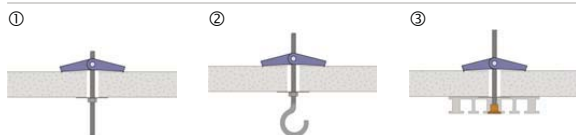

- ① Construction with thread connection.
- ② Fixing of lamps.
- ③ With brass slotted sleeve washer for curtain rail fixings.
- Fixings of shelves, cable channels, cavity brick ceilings, chipboards, gypsum fiber boards.

Installation

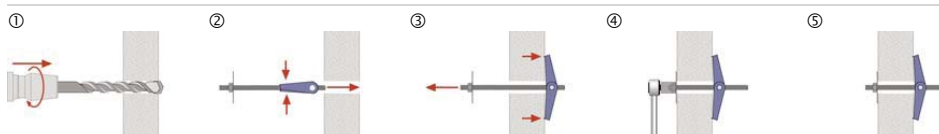

- ① Take drill hole- \varnothing and drill hole depth from the table.
- ② Press the wings together and push the Cavity Toggle through the hole.
- ③ Pull back the Cavity Toggle until the points on the wings anchor in the base material.
- ④ Turn in the thread if needed, tighten the nut on the Cavity Toggle.
- ⑤ Adjustment is possible at anytime.

All information detailed in our data sheets is based on technical approvals, formulas and site and laboratory testing under optimum conditions and include a stated safety factor. As we have no direct or indirect control over where or how our products are applied or installed, we do not accept any liability either directly or indirectly arising from the use of our products, whether or not in accordance with any advice, specification or recommendation given by us and we recommend site testing of all products for suitability.

Name		MF-M3	MF-3H	M 3M	MF-M4	MF-4H	M 4M	MF-M5	MF-5H	MF-M6	MF-6H	MF-M10	
With threaded rod		x			x			x		x		x	
With hook			x			x			x		x		
With brass slotted sleeve washer				x			x						
Recommended tension loads:													
N _{Emp}	- Gypsum plasterboard d = 12.5 mm ¹⁾			0.16		0.2		0.22		0.22		0.24	
	- Wood plate d = 13 mm ¹⁾			0.3		0.35		0.38		0.38		0.41	
	- Cement Fiber board d = 12 mm ¹⁾			0.33		0.57		0.62		0.62		0.68	
	- MF-H ²⁾			25		75		0.2		0.2		0.25	
h _e	Min. insertion depth	mm	35		35		46		46		90		
d _s	Thread-Ø	mm	3		4		5		6		10		
l _s	Thread length	mm	85	70	85	90	70	90	100	70	100	90	180
SW	Spanner size	mm	5.5		7		8		10		17		
d ₀	Drill hole-Ø in the building material	mm	11		14		16		16		30		
l _k	Usable length max.	mm	50	30	50	50	30	50	60	30	60	50	150
d ₀	Ø Disc	mm	20		20		30		30		38.5		
d _k	Supporting width	mm	43		53		60		75		146		



Cavity Toggle MF-M / MF-H / MF-MM

- 1) Safety factor 4
- 2) Hook-deformation: Safety factor 4